



**18 Berry Street FAWKNER VIC**

3 1 4

Sitting pretty on a sizeable block, measuring approximately 600m<sup>2</sup>, finds this neatly updated three bedroom double fronted brick residence.

Offering immense appeal for owner occupiers, market entrants and investors alike, the property is conveniently located just minutes from Charles Mutton Reserve, Fawkner station, St Marks Primary and Fawkner Primary.

Whilst especially appealing for renovators, builders and developers it also boasts wide street frontage, side driveway and deep backyard offering plenty of scope to extend, build new or redevelop (STCA).

Step inside to a spacious lounge featuring a painted brick fireplace and large glass aspect.

Enjoying views of the rear garden, and side access to a covered outdoor area where you can relax, entertain and

**Type** : House

**View** : <https://www.peterleahy.com.au/sale/vic/north/fawkner/residential/house/7434892>

[For full version visit the website](https://www.peterleahy.com.au)

18 BERRY STREET, FAWKNER

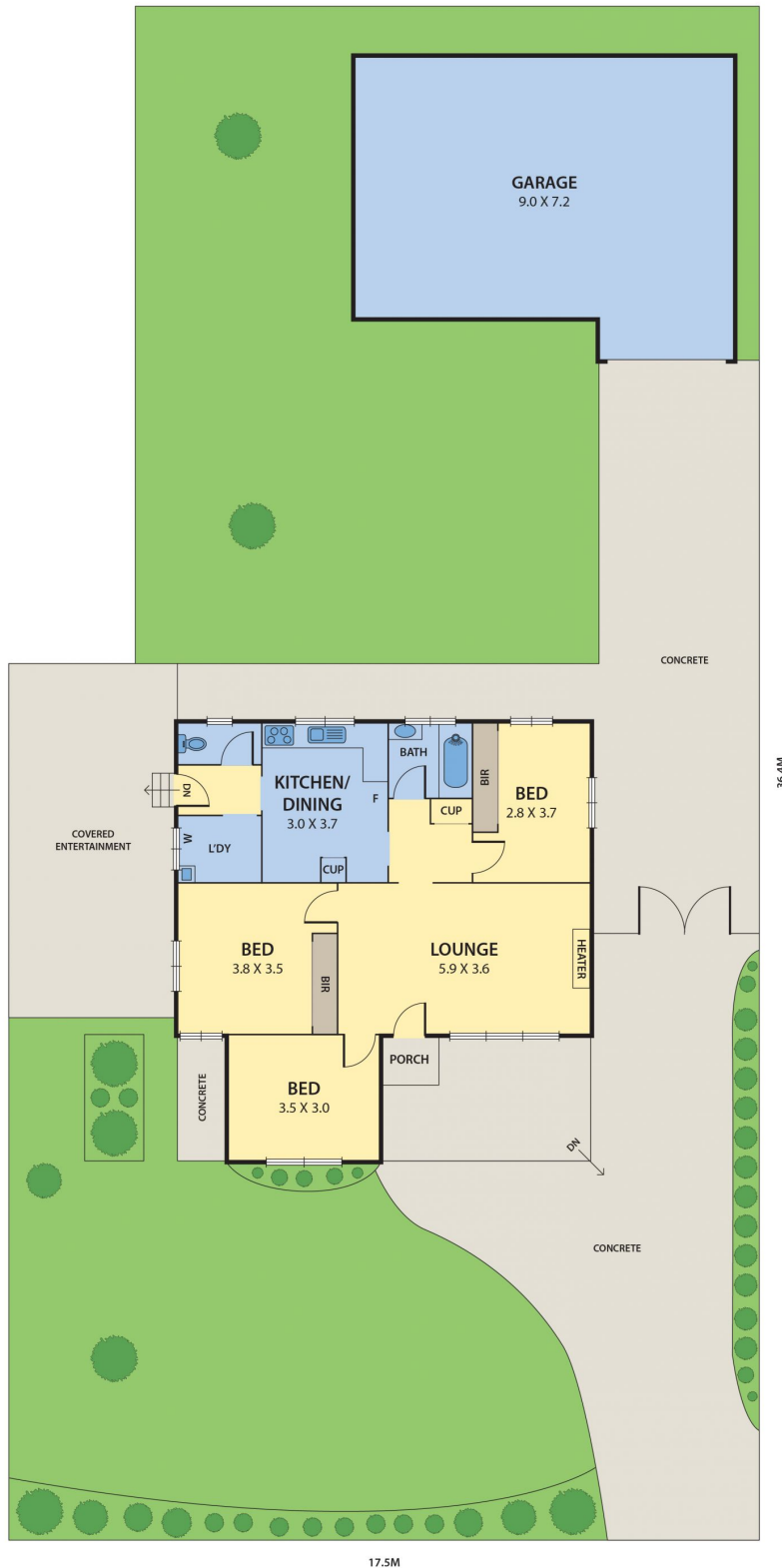

DISCLAIMER:

Please note plans are indicative only and not drawn to exact scale.  
All dimensions are approximate